

NOTE:
SPRAY WITH ANTIDESCANT IN ACCORDANCE WITH MFG.'S
RECOMMENDATIONS IF FOLIAGE IS PRESENT.

1 SHRUB PLANTING DETAIL FOR ALL SHRUBS BALLED & BURLAPPED NOT TO SCALE

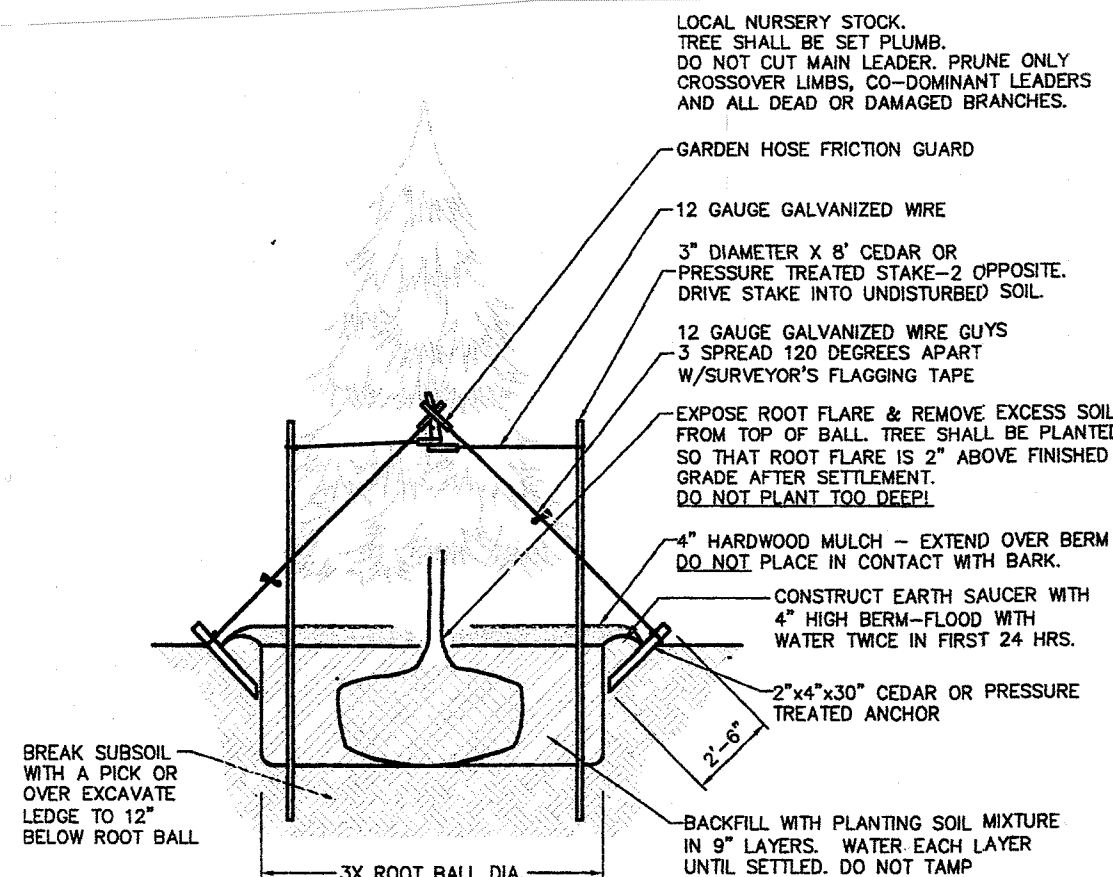

NOTES:
1. SPRAY WITH ANTIDESCANT IN ACCORDANCE WITH MFG.'S RECOMMENDATIONS.
2. TREES LESS THAN 8' HEIGHT SHALL BE STAKED.
3. TREES GREATER THAN 8' HEIGHT SHALL BE GUYED AND ANCHORED.
4. STAKES SHALL BE REMOVED AT THE END OF THE FIRST GROWING SEASON AFTER PLANTING.

2 EVERGREEN TREE PLANTING NOT TO SCALE

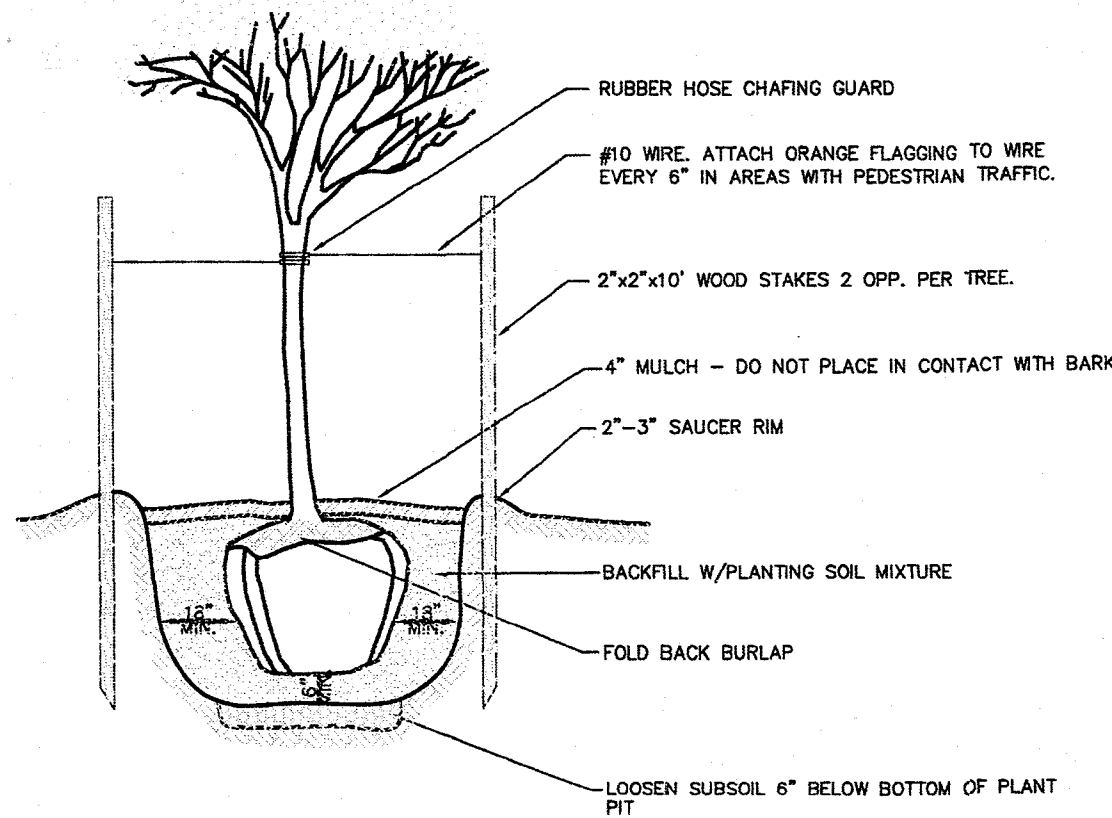

3 DECIDUOUS TREE NOT TO SCALE

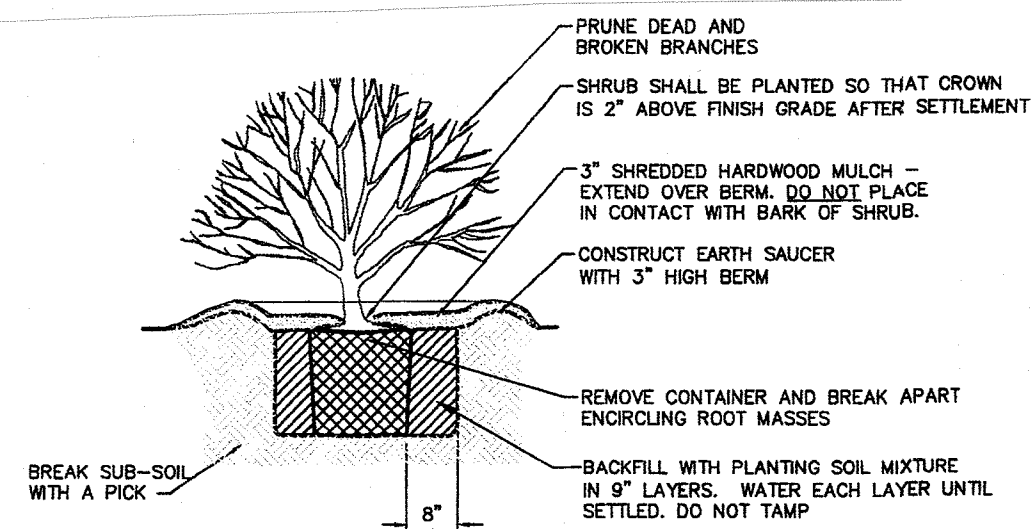

NOTE:
SPRAY WITH ANTI-DESCANT IN ACCORDANCE WITH
MFG.'S RECOMMENDATIONS IF FOLIAGE IS PRESENT.

FOR CONTAINER GROWN SHRUBS, USE FINGERS OR SMALL HAND TOOLS TO PULL THE ROOTS OUT OF THE OUTER LAYER OF POTTING SOIL; THEN CUT OR PULL AWAY ANY ROOTS CIRCLING THE PERIMETER OF THE CONTAINER.

INCORPORATE COMMERCIAL PREPARED MYCORRHIZA SPORES IN THE SOIL IMMEDIATELY AROUND THE ROOT BALL AT RATES SPECIFIED BY THE MANUFACTURER.

4 SHRUB PLANTING DETAIL FOR CONTAINERIZED SHRUBS NOT TO SCALE

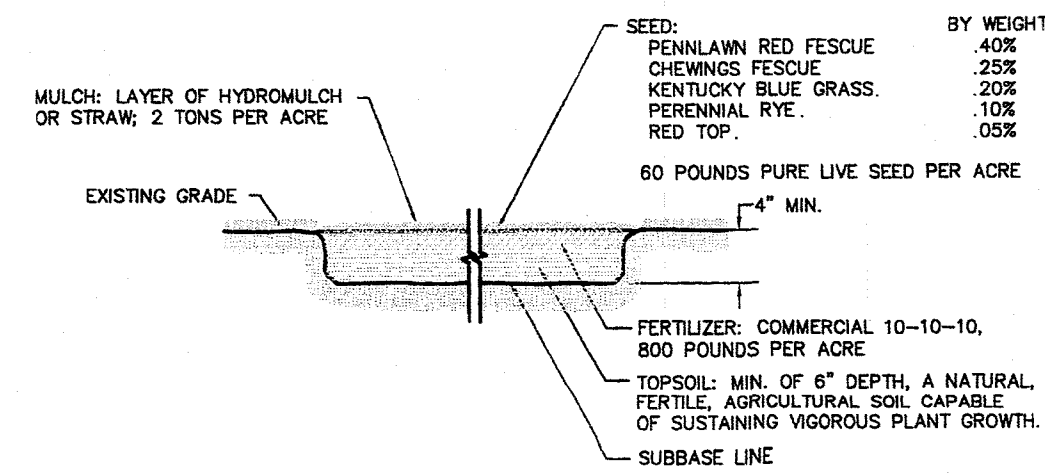

NOTE:
1. DETAIL REPRESENTS PERMANENT SEEDING IN FORMAL LAWN AREAS ADJACENT TO THE BUILDING AND WITHIN THE LIMITS OF THE DETENTION BASINS.

5 TOPSOIL, FERTILIZER, SEED & MULCH NOT TO SCALE

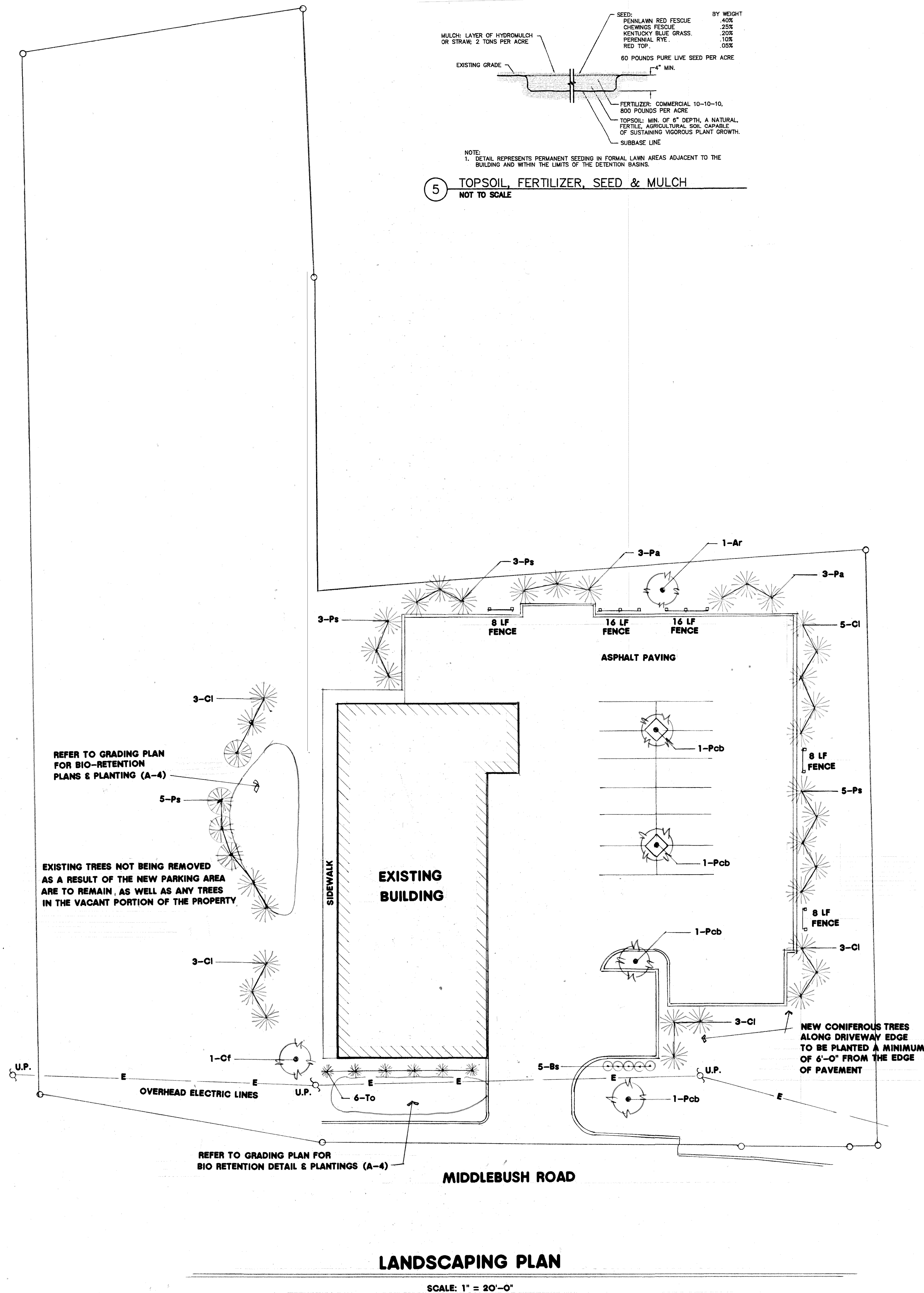

LANDSCAPING NOTES

- The work of furnishing and planting trees, shrubs and vines as shown on the plans and as approved by the Planning Board will be accomplished in accordance with accepted, established horticultural practices. Any change in plan type, etc., or location requires the written approval of the Planning Board.
- Plants: Common and scientific names of plants shall be in conformity with SPN (Standardized Plant Names). Plants including root spread and ball size shall be accordance with the current edition of "American Standard for Nursery Stock".
- Plants shall have a normal habit of growth and be typically characteristic of their respective kinds.
- Plants shall be free from injury, insect damage, and disease.
- Container grown plants shall have been grown long enough for new fibrous roots to have developed. Shrubs and vines shall have good fibrous root systems.
- No planting will be done when there are unsatisfactory conditions as determined by the Architect.
- Rock or other underground obstructions shall be removed to a depth as directed by the Architect.
- All plants shall be protected from drying out.
- Locations of plantings shall be marked out on the ground by the contractor to the satisfaction of the Architect.
- All plants will be set in accordance with good established horticultural practice.
- All plants shall be set plumb at such a level that after settlement they bear the same relationship to the level of the surrounding ground as they bore to the ground from which they were dug unless otherwise directed by the Architect.
- Backfill shall be thoroughly settled by tamping. Backfill is to be placed into plant pits in layers not to exceed 4" and tamped.
- Thorough watering should accompany backfill unless otherwise directed by the Architect. A saucer capable of holding water to a depth as shown on the plans shall be formed about each plant pit. All plants shall be watered to provide not less than five gallons of water per square yard of plant pit or bed areas.
- All cloth ropes, etc. shall be removed from the tops of balls, but not pulled out from under the balls.
- All trunks of deciduous trees shall be wrapped with a material as approved by the Architect immediately after planting.
- All trees shall be firmly guyed, staked, or anchored unless otherwise approved.
- Pruning shall be done in accordance with accepted good horticultural practice as directed by the Architect.
- Mulching shall cover the plant pit or planting bed to a depth as specified on the plans.
- The area disturbed by the planting operation shall be restored to an orderly condition as approved by the Architect.
- Anti-desiccants shall be applied to all plantings according to the manufacturer's directions. This material shall be applied to evergreens within two weeks of planting and to deciduous plantings placed in the fall when air temperature is above 40 degrees F or in the spring when leaves have reached 75% of mature size.
- All dead, unhealthy or badly impaired plants, as determined by the Architect, shall be promptly removed from the project.
- In the event of the threat of serious damage from insects, disease or rodents, the plants will be treated in accordance with good horticultural practice as approved by the Architect.
- All vegetation shown on this plan shall be maintained in a healthy and vigorous growing condition throughout the duration of the proposed use. All vegetation not so maintained shall be replaced with new comparable vegetation at the beginning of the next growing season.
- All planted areas where trees and/or shrubs are indicated, to have beds of whitewashed stone or pine bark chips as noted on plans.
- All remaining and disturbed areas not paved or being planted with trees or shrubs shall be seeded and mulched.
- Contractor to be responsible for bringing topsoil to site as necessary for proper seeding and planting.
- All planting shall be guaranteed by contractor a minimum of one year and be replaced as necessary.
- Fertilize and/or feed all plantings as recommended.
- After seeding germinates, contractor to be responsible for raking, mulching, re-seeding as necessary and cutting and maintaining lawn for a period of one month after germination and to the Architect's satisfaction.

PLANTING SCHEDULE

Mark	Quantity	Botanical Name	Common Name	Size
Ar	1	Acer Rubrum	Red Maple	2 1/2"-3" c
Bs	5	Buxus Sempervirens	Dwarf English Boxwood	3 gal.
Cf	1	Cornus Florida	Flowering Dogwood	2 1/2"-3" c
CI	17	Cupressus Leylandi	Leyland Cypress	6' ht.
Pa	6	Picea Abies	Norway Spruce	6' ht.
Pcb	4	Pyrus Calleryana	Bradford Pear	2 1/2"-3" c
Ps	16	Pinus Strobus	White Pine	6' ht.
To	6	Thuja Occidentalis	Emerald Green Arborvitae	6' ht.

REVISIONS	BY

ALFRED A. CAPPELLI JR., AIA
ARCHITECT
1136 ROUTE 9 WAPPINGERS FALLS, N.Y. 12590
Phone: (845) 632-6500
acappe2102@aol.com

PROPOSED CONTRACTOR STORAGE BUILDING
33 MIDDLEBUSH LLC
33 MIDDLEBUSH ROAD TOWN OF WAPPINGERS, NY

LANDSCAPING PLAN, NOTES & DETAILS

AUG. 1, 2019
DATE
MAY 1, 2019
SCALE
1" = 20'
DRAWN
AC
JOB
16-034
SHEET
S-3
OF SHEETS