

- LEGEND:**
- EXISTING PROPERTY LINE
 - ADJOINING PROPERTY LINE
 - EXISTING EASEMENT LINE
 - EXISTING STREAM
 - EXISTING WETLAND BOUNDARY
 - 100' WETLAND BUFFER
 - EXISTING MAJOR CONTOUR
 - EXISTING MINOR CONTOUR
 - EXISTING TREE LINE
 - EXISTING OVER HEAD WIRE
 - EXISTING UTILITY POLE
 - EXISTING SEWER SERVICE LINE
 - EXISTING SEWER LINE
 - EXISTING SEWER MANHOLE
 - EXISTING SEWER CLEAN OUT
 - EXISTING WATER LINE
 - EXISTING WATER SERVICE LINE
 - EXISTING WELL
 - EXISTING HYDRANT
 - EXISTING WATER SHUT OFF VALVE
 - EXISTING WATER VALVE
 - EXISTING STORM WATER LINE
 - EXISTING ROOF LEADER
 - EXISTING CATCH BASIN

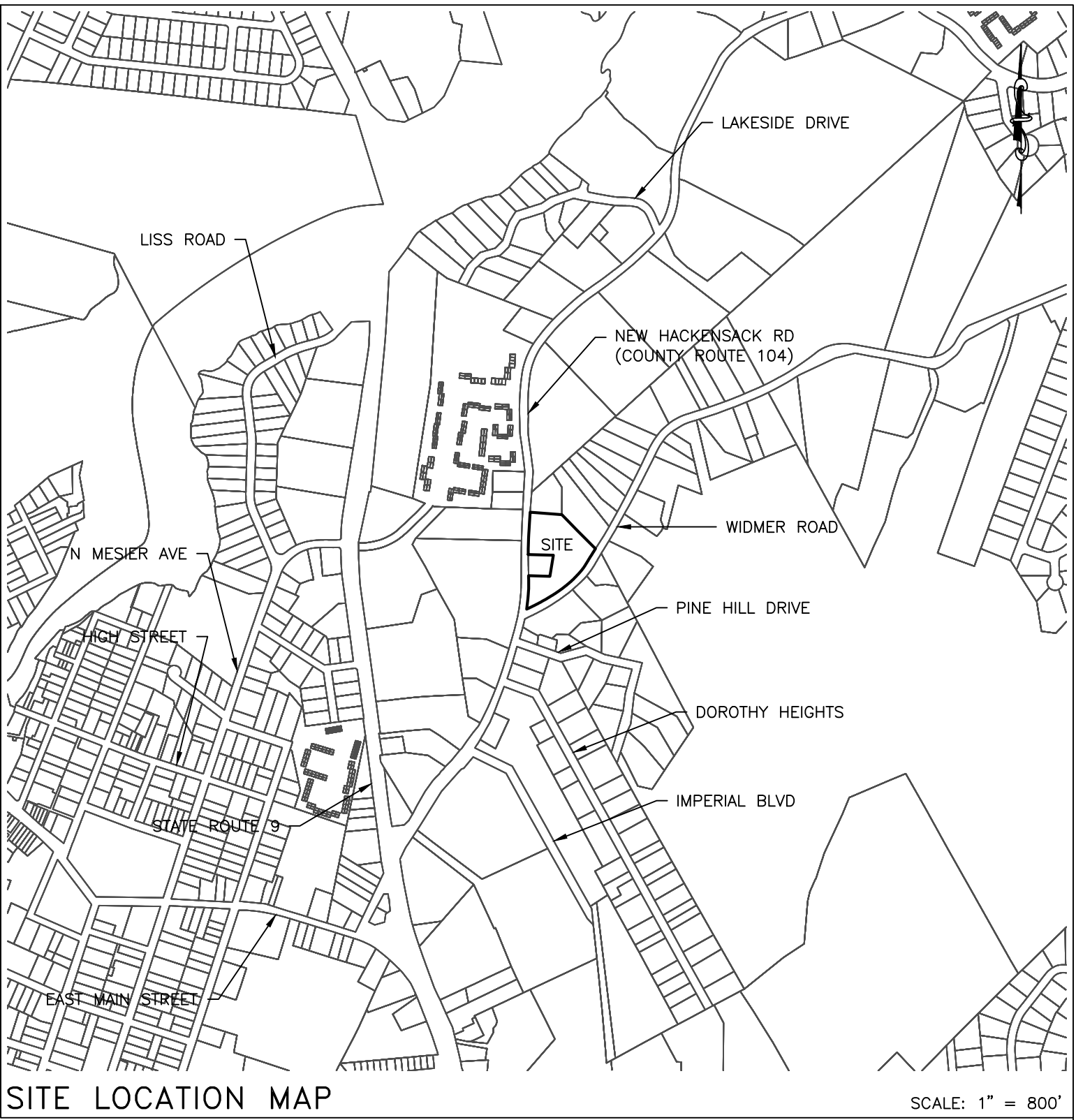

PROJECT INFORMATION:	
PARCEL OWNER:	SUBEN LLC; 136 FULTON STREET, POUGHKEEPSIE NY 12601
PROJECT ENGINEER:	HUDSON LAND DESIGN P.C., 174 MAIN STREET, BEACON NY 12508
PARCEL LOCATION:	NEW HACKENSACK & WIDMER ROAD, WAPPINGER NY 12590
TAX PARCEL ID:	6158-04-632426
PARCEL AREA:	2.31-ACRES
WATER SUPPLY:	PROPOSED PRIVATE WELL
SEWAGE DISPOSAL:	PROPOSED PRIVATE SDS

DRAWN BY: CMB				CHECKED BY: MAB			
REVISIONS:				REVISIONS:			
NO.	DATE	DESCRIPTION	BY	NO.	DATE	DESCRIPTION	BY

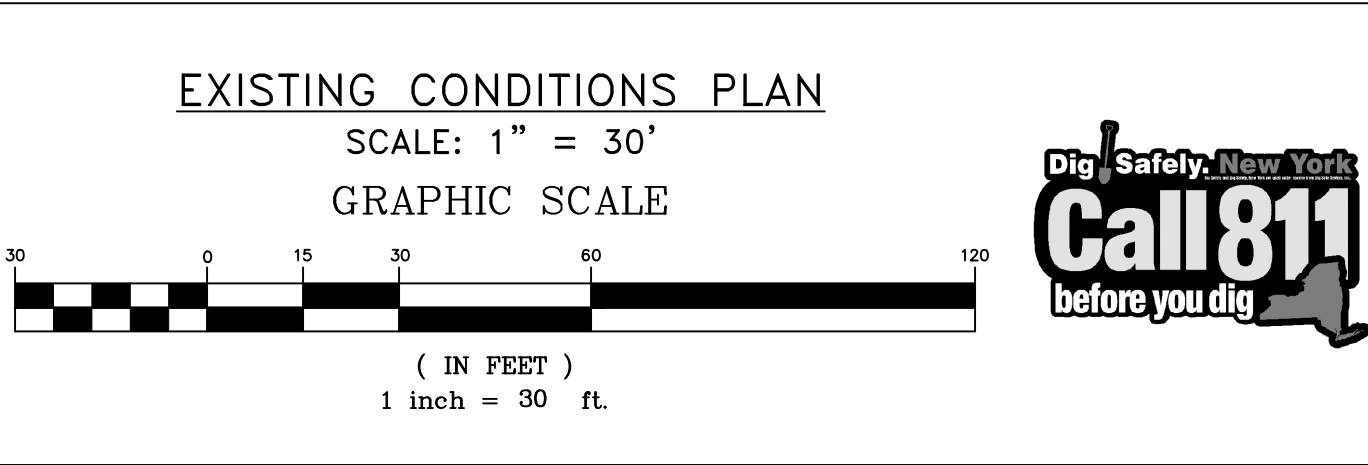

HUDSON LAND DESIGN
PROFESSIONAL ENGINEERING P.C.
174 MAIN ST., BEACON, NEW YORK 12508
13 CHAMBERS ST., NEWBURGH, NEW YORK 12550
PH: 845-440-6926

EXISTING CONDITIONS PLAN		JOB #: 2023031
SUBEN LLC SUBDIVISION		DATE: 12/6/2023
NEW HACKENSACK ROAD TOWN OF WAPPINGER DUTCHESS COUNTY, NEW YORK TAX ID: 6158-04-632426		SCALE: 1" = 30'
		TITLE: XC-1
		SHEET: 1 OF 3